



Product Data Sheet

DC108

Surface - overhead - floor mount contact

Overhead Door Magnetic Contact

The DC108 series overhead door magnetic contact is for use in the rigorous environments of commercial and industrial installations. The floor mount units are constructed with a low profile heavy cast aluminium housing. The reed switch assembly is fully encased in an exclusive polyurethane potting material to prevent damage due to moisture or humidity.

Easy Installation

A wide operating gap distance of up to 7.5 cm makes installation easy and helps prevent false alarms caused by door movement or damaged and loose fitting doors.



Standard Features

- Miniature, low-profile design
- Stainless steel armoured cable for added security, reliability
- Wide working gap for overhead doors
- Small size less likely to be damaged by forklifts
- Tamper loop provided

DC108

Surface - overhead - floor mount contact

Specifications

Operating gap	75 mm (max.)
Connections (armoured cable)	4 wires, 2 m
Contact type	NC
Dimensions (W x H x D)	
Magnet	89 x 38 x 38 mm
Contact	89 x 38 x 38 mm
Material	Aluminium

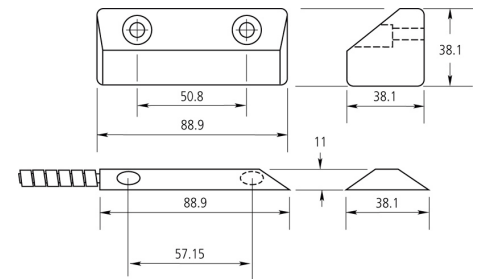

Ordering Information

Part No.	Description
DC108	Surface - overhead - floor mount contact
DC108R4.7	Surface - overhead - floor mount contact with 4.7K resistor
DC140	Surface - overhead - floor mount contact - anti-corrosion
DC109	Surface - overhead - floor mount contact - extra heavy duty